

Belt, Platen Open, Adjustment (Figure 4-2)

1. Prepare the printer for maintenance (page 4-2).
2. Open the printer cover.
3. Remove the platen open belt cover (1) by squeezing the top and bottom to release the plastic tabs from the slots in the side plate.
4. Loosen the motor mount screws (2).
5. Close the forms thickness lever all the way.

CAUTION

Too much tension on the platen open belt can cause the platen gap to change, which can lead to premature wear of the platen, damaged hammer tips, and poor print quality.

6. Using a force gauge, apply 10 ± 1 pounds of tension to the platen open motor shaft (3), pulling away from the large platen pulley.
7. Reduce tension to 5 ± 1 pounds and torque the motor mount screws (2) to 11 ± 2 inch-pounds.
8. Check the platen gap (page 4-14). Loosen the belt and readjust the gap if necessary.
9. Snap the platen open belt cover (1) into the slots in the side plate.
10. Return the printer to normal operation (page 4-22).

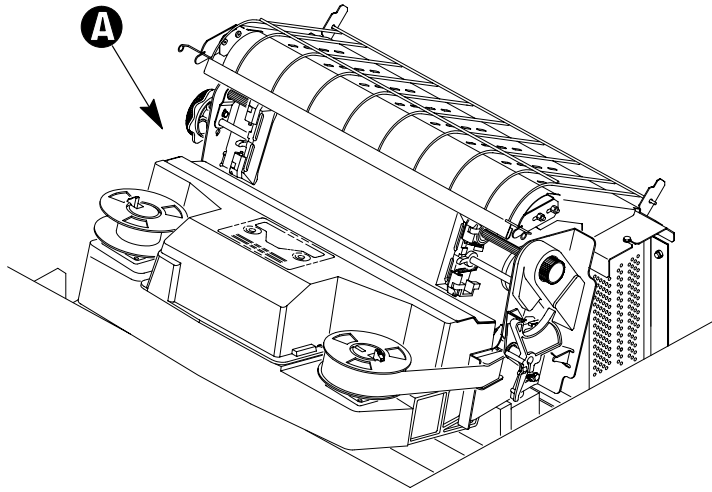

- 1. Belt Cover
- 2. Motor Mount Screw
- 3. Platen Open Motor Shaft

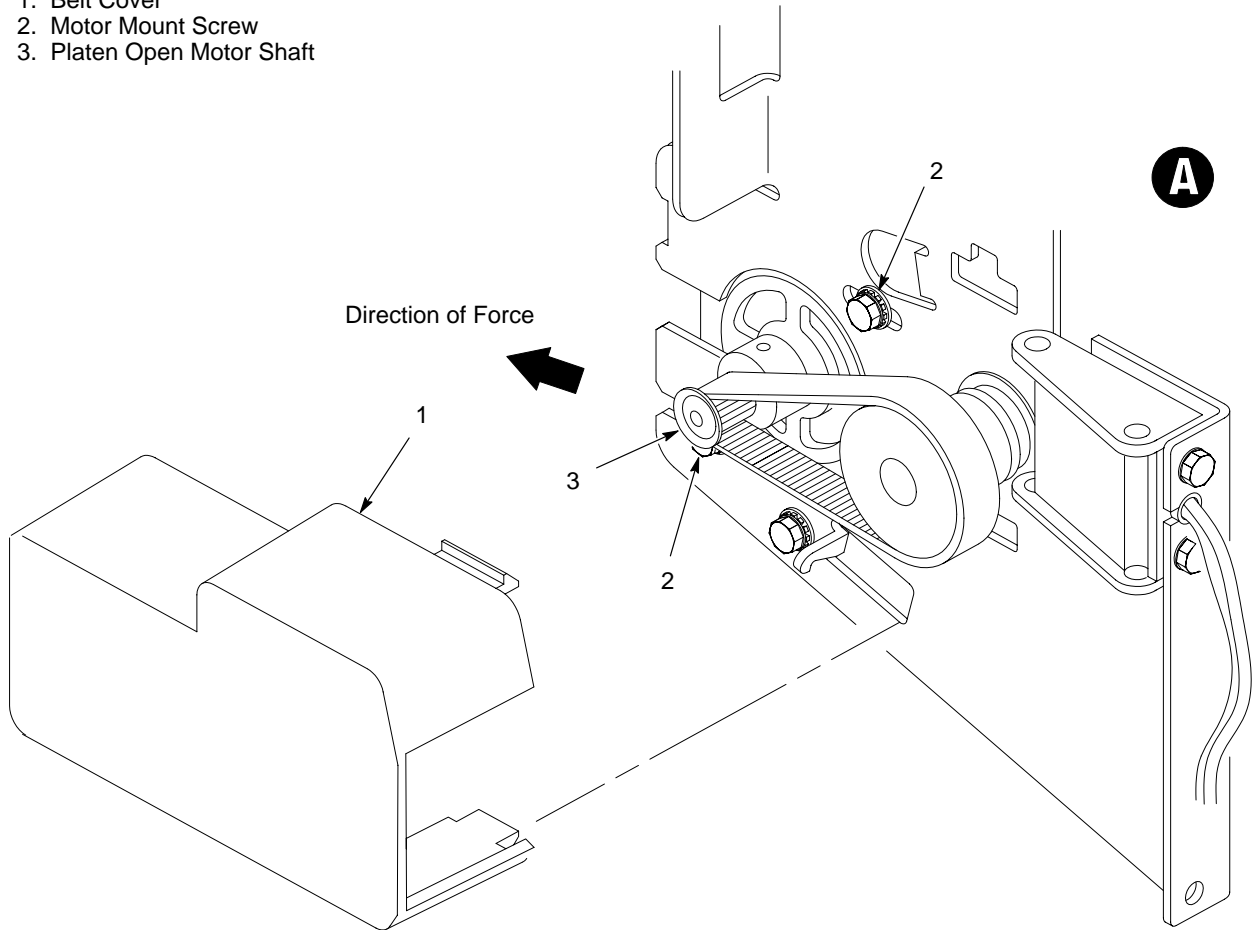

Figure 4-2 . Platen Open Belt Adjustment