

Shuttle Frame Assembly (Figure 5–31)

Removal

1. Prepare the printer for maintenance (page 5–3).
2. Remove the shuttle cover assembly (page 5–24).
3. Disconnect the MPU cable connector (1).
4. Disconnect the shuttle motor cable connector (2).
5. Disconnect the shuttle cable assembly connector (3).

CAUTION

The hammer bank flex circuit ribbon cables can tear if handled roughly. Do not pull on the cables; grasp the connectors to disconnect the flex circuit ribbon cables. In the next step, disconnect the left and right flex ribbon connectors gently, and do not bend the cables unnecessarily.

6. Disconnect the left and right hammer bank flex circuit ribbon connectors (4 and 5).
7. Loosen the side 5/32 inch socket head clamp screws (6) and pull the clamps (7) back and off the guide shaft (8). Do not remove the clamps.
8. Loosen the center 5/32 inch socket head screw (9) enough to release the shuttle frame assembly (10) from the base casting (11).
9. Unlock and slide the tractors (13) outward as far as they will go on the tractor support shaft (14).
10. Grasping the outer beam standoffs (12), lift the shuttle frame assembly (10) out of the base casting (11). Lift it slowly and carefully: the shuttle frame assembly is heavy.

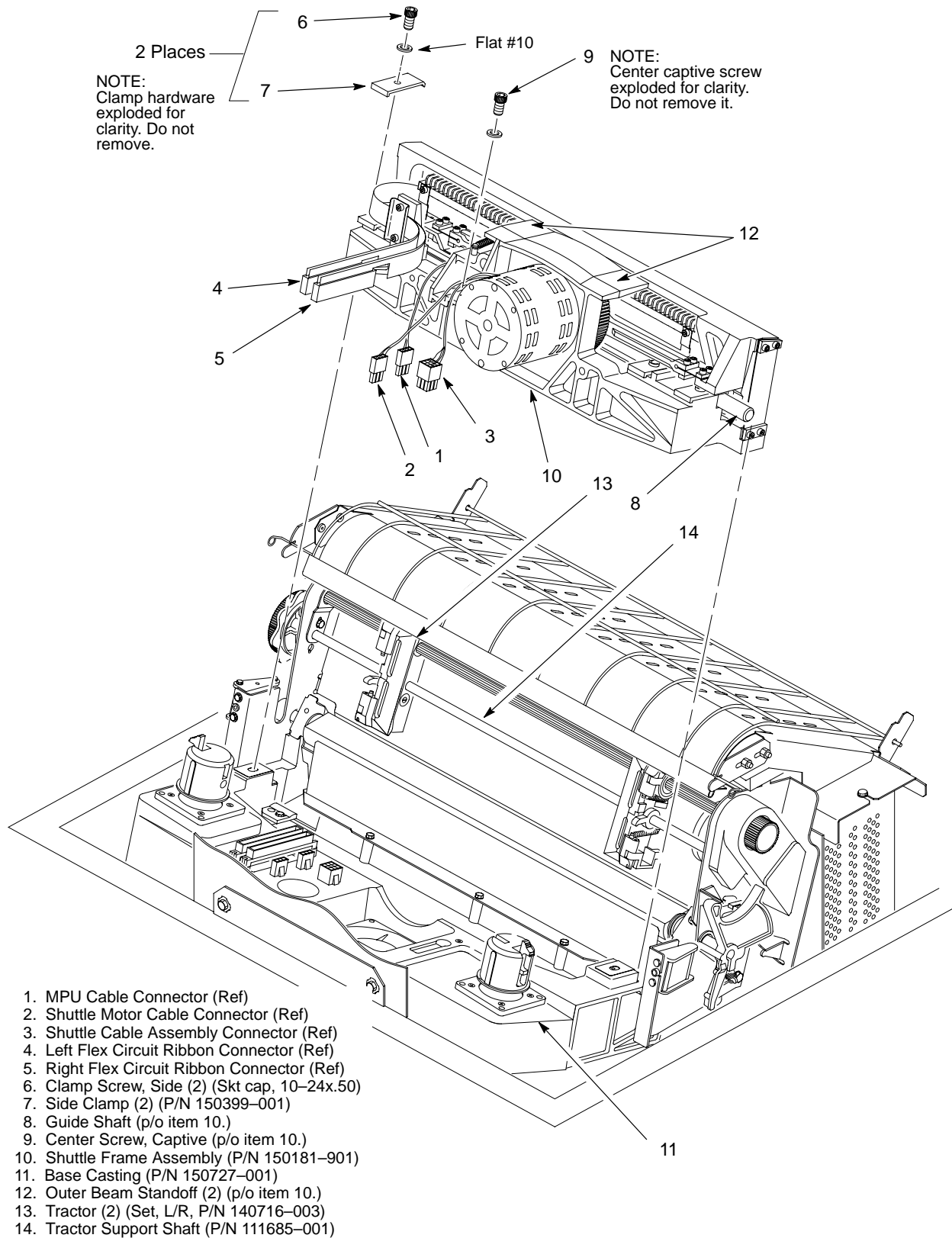

Figure 5-31 . Shuttle Frame Assembly Removal/Installation

Hammer Spring Assembly (Figure 5–13)

Removal

1. Prepare the printer for maintenance (page 5–3).
2. Remove the shuttle frame assembly (page 5–72).
3. Remove the hammer bank cover assembly (page 5–22).
4. Remove three 5/64 inch socket head screws from the old hammer fret.
5. Using the pointed end of the nylon stick supplied in the hammer spring replacement kit, carefully pry the old hammer fret off its mounting pins as shown in Figure 5–13 .
6. Discard the old hammer fret and mounting screws.

Installation

IMPORTANT

FRET ONE is on the RIGHT END of the hammer bank as you face the hammer springs. FRET SEVEN is the LEFT END of the hammer bank. If you accidentally bend the wrong hammer, do not attempt to rebend the hammer and do not install that fret.

Make sure the hammer bank surface under the fret is clean before installing a new fret. Dirt or debris between the fret and hammer bank can cause misalignment, degraded performance, or damage to hammers.

1. If you are replacing one of the inner frets, go to step 2.
If you are replacing fret seven, bend the left–most hammer spring as shown in Figure 5–13 before removing it from the box. If you are replacing fret one, bend the right–most hammer spring as shown in Figure 5–13 before removing it from the box. Go to step 2.
2. Remove the new fret and mounting screws from the box.
3. Install the new fret on the hammer bank mounting pins and press it into position with the flat end of the nylon stick supplied in the hammer spring replacement kit.
4. Install the screws from the replacement kit. Torque each screw to 8 ± 1 in–lbs in the order shown in Figure 5–13 .
5. Install the hammer bank cover assembly (page 5–22).
6. Install the shuttle frame assembly (page 5–72).
7. Return the printer to normal operation (page 5–86).

Preparation – Frets 1 and 7 only

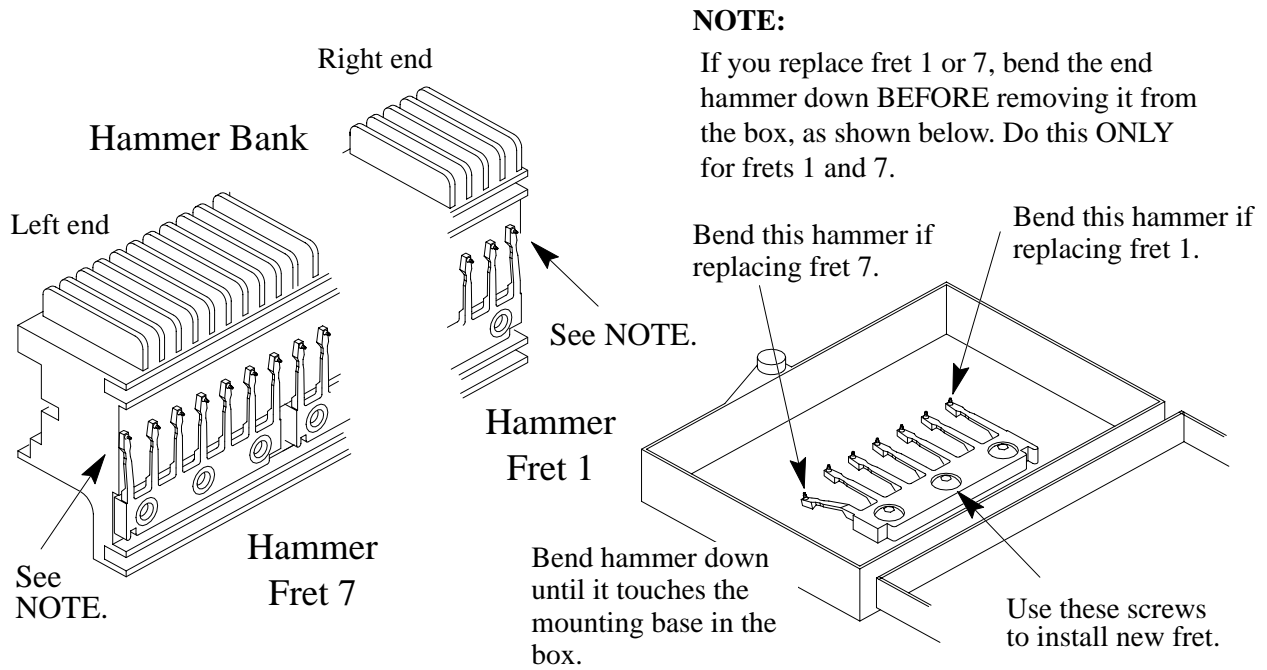

Removal – Any Fret

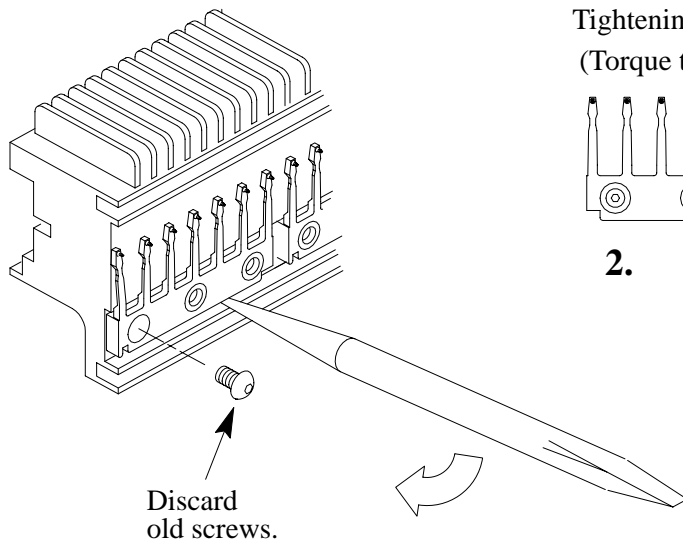

Hammer Spring Replacement Kit: P/N 112251-001

Installation – Any Fret

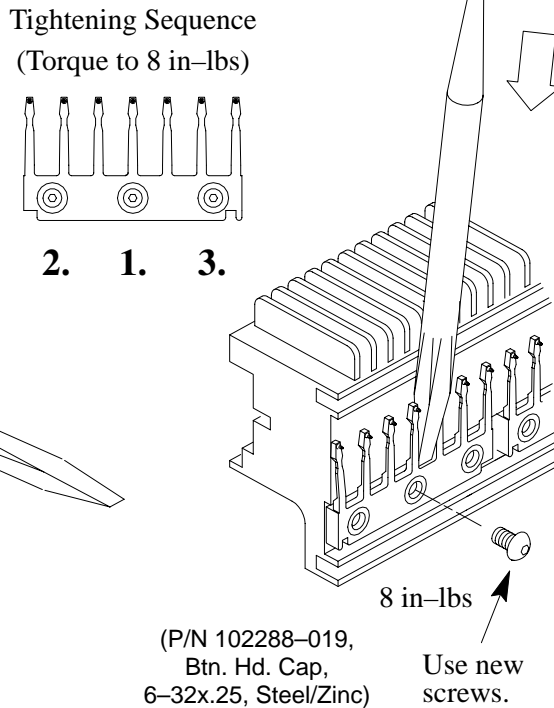

Figure 5-13 . Hammer Spring Assembly Removal/Installation

Installation

1. Install the hammer bank cover (page 5–22), if it was removed.
2. Holding the shuttle frame assembly (10) by the outer beam standoffs (12), set it into the base casting (11). Use both hands: the shuttle frame assembly is heavy.
3. Align the center 5/32 inch socket head screw (9) in the base casting (11) and hand turn the screw until only two or three threads have started.
4. Pull the shuttle frame assembly (10) toward the front of the printer and hold it in this position while you do step 5.
5. Slide the side clamps (7) over the guide shaft (8) and torque the 5/32 inch socket head clamp screws (6) to 20 ± 2 inch-pounds.
6. Lift up on the shuttle motor, then gently set it down to align the center screw guide.
7. Torque the center captive 5/32 inch socket head screw (9) to 20 ± 2 inch-pounds.
8. Connect the left and right hammer bank flex circuit ribbon connectors (4 and 5).
9. Connect the shuttle cable assembly connector (3).
10. Connect the shuttle motor cable connector (2).

CAUTION

Make sure the MPU cable is below the extension spring and does not touch the spring after the cable is connected.

11. Connect the MPU cable connector (1).
12. Loosen the platen open belt (page 4–4, steps 3. and 4.).
13. Adjust the platen gap (page 4–14).
14. Adjust the platen open belt (page 4–4).
15. Check the platen gap again. Readjust if necessary (page 4–14).
16. Install the shuttle cover assembly (page 5–24).
17. Return the printer to normal operation (page 5–86).

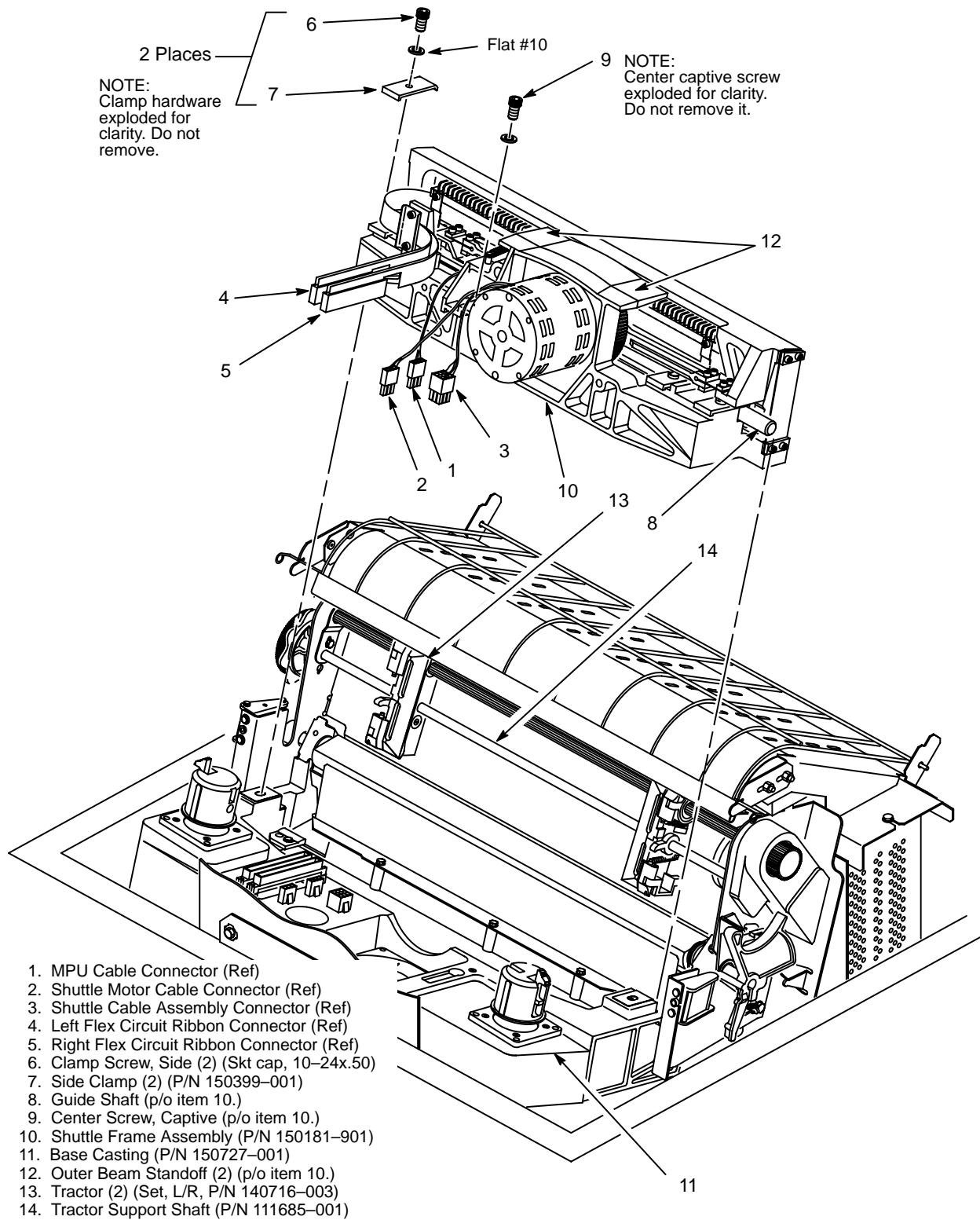

Figure 5-31 . Shuttle Frame Assembly Removal/Installation