

5-4. Ribbon Tracking Check and Adjustment (Figure 5-2)

1. Make sure paper is loaded in printer and a full ribbon spool is on the right hand side.
2. On pedestal models, loosen two fasteners (1) and allow rear door (2) to swing down. Swing out card cage (3). Open front cover (4). On XQ models, remove right side panel per paragraph 5-18a.
3. Set POWER to ON.
4. Set Forms Thickness Adjustment Lever to any position between open and 6. Make sure no error indications appear.
5. Press and release ON LINE switch. Shuttle action and ribbon motion should begin.

– **WARNING** –

Connector J4 on the power supply PCBA must be connected any time the printer motor is turned on. If it is not, printer will draw excessive current and may be damaged. Never disconnect J4 while printer power is ON.

6. Press ON LINE switch as required to keep shuttle motor running constantly.
7. If the ribbon is not already running from right to left, on left ribbon guide (7) momentarily short across skids (8).
8. Verify ribbon is centered in left guide (7). If not, see below. Allow all ribbon to run past guide during check and adjustment.
 - (a) Loosen two screws (9) with washers (10) until guide (7) can be rotated about guide post (11).
 - (b) Pivot guide (7) until ribbon tracks in center.
 - (c) Tighten screws (9).
 - (d) Verify ribbon is centered on guide (7).
9. On right ribbon guide (12) momentarily short across skids (13).
10. Perform step 8 for right ribbon guide. Allow enough ribbon to run through guide to verify proper tracking.
11. Repeat steps 7 through 10 and readjust as necessary.

NOTE: Ribbon hub height check and adjustment may be performed here.

12. Set POWER to OFF.
13. On pedestal models, close front cover (3). Close rear door (2). Engage and tighten two fasteners (1). On XQ models, install right side panel per paragraph 5-18b.

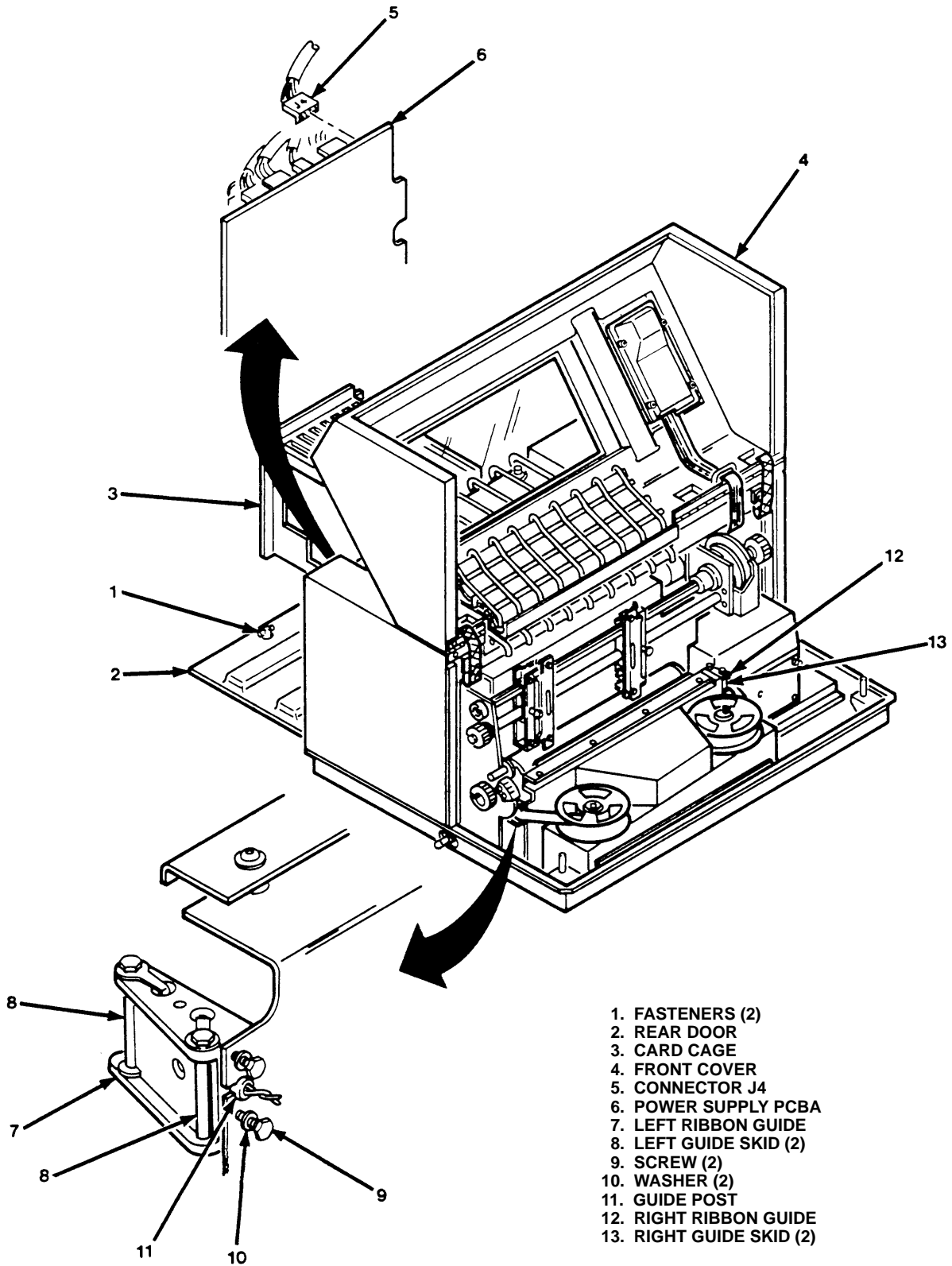

- 1. FASTENERS (2)
- 2. REAR DOOR
- 3. CARD CAGE
- 4. FRONT COVER
- 5. CONNECTOR J4
- 6. POWER SUPPLY PCBA
- 7. LEFT RIBBON GUIDE
- 8. LEFT GUIDE SKID (2)
- 9. SCREW (2)
- 10. WASHER (2)
- 11. GUIDE POST
- 12. RIGHT RIBBON GUIDE
- 13. RIGHT GUIDE SKID (2)

Figure 5-2. Ribbon Tracking Check and Adjustment